

LUMINAIRE TYPE B



LUMINAIRE TYPE A

LIGHTING CALCULATIONS RESULTS
 Eav = 14.6 LUX
 Emin = 1.8 LUX
 Emin/ Eav = 0.13 LUX

- Key
- Luminaire A Column
 - Luminaire A HWD-#4LED870-S1
 - Luminaire B Bollard
 - Luminaire B LHR-B1PLFED50

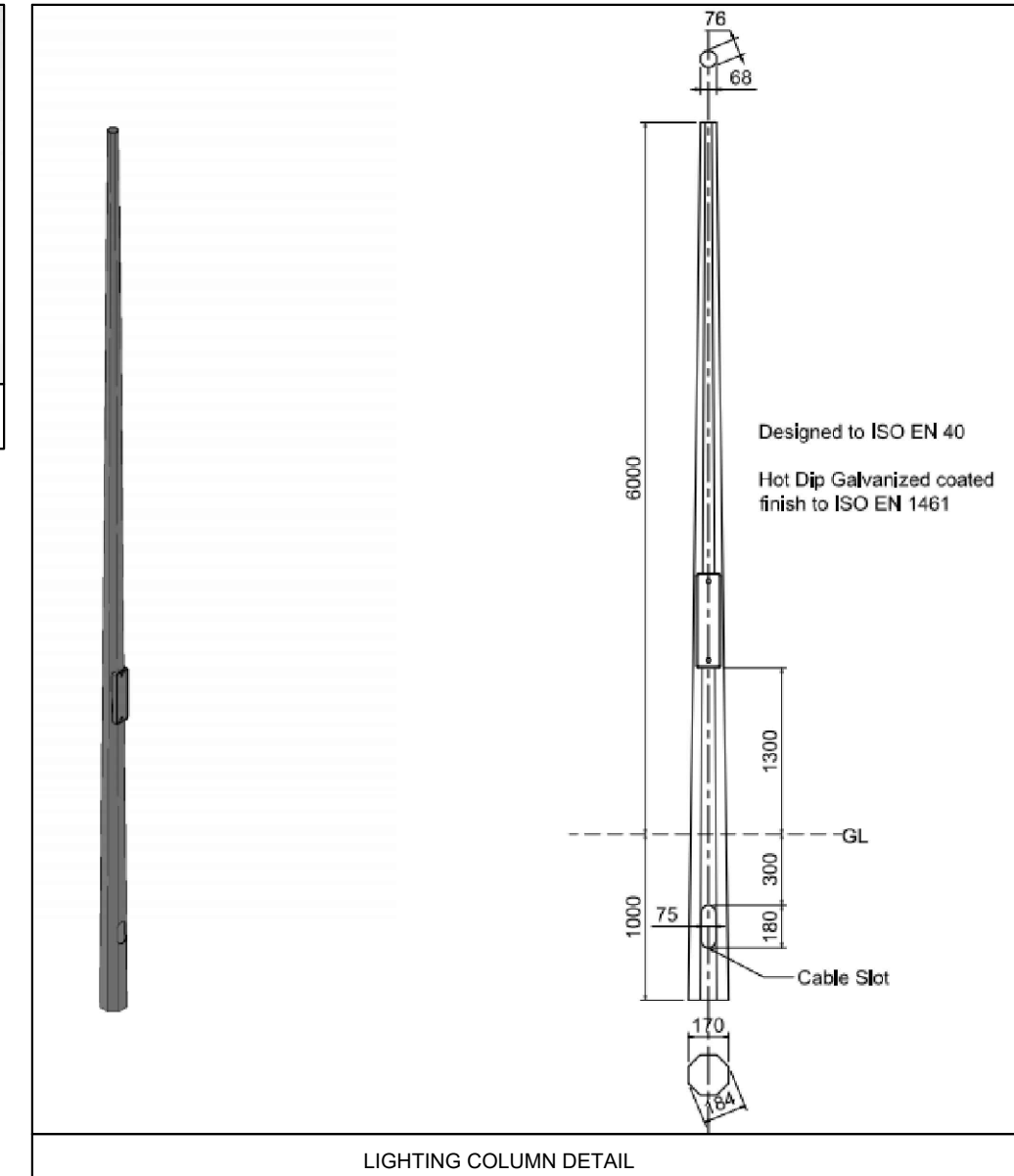

LIGHTING COLUMN DETAIL

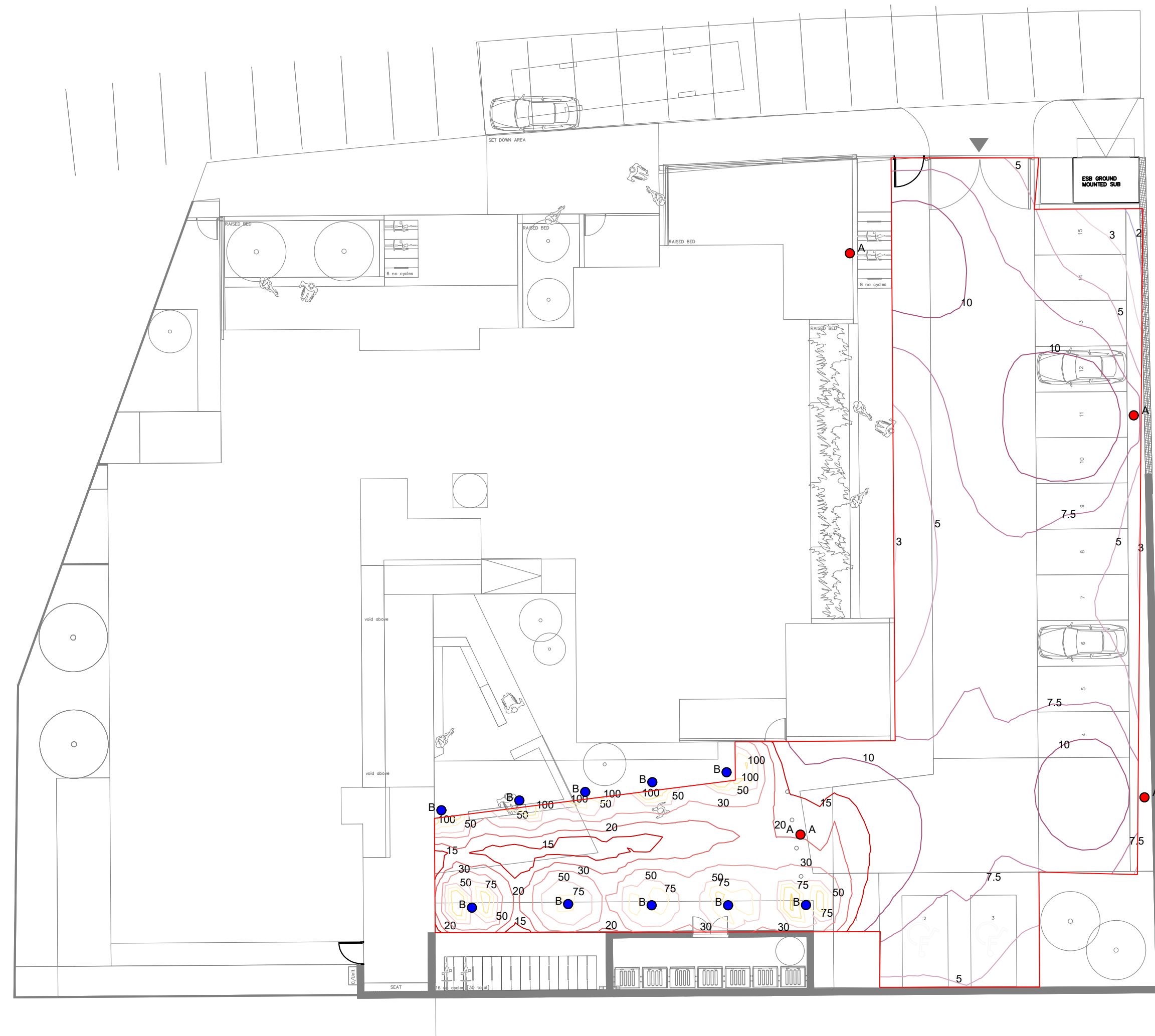

Copyright ©
 No part of this document may be re-produced or transmitted in any form or stored in any retrieval system of any nature without the written permission of the consultant as copyright holder excepts as agreed for use on the project for which the document was originally written.

General notes:
 This drawing to be read in conjunction with all relevant architectural drawings and specifications.
 This drawing to be read in conjunction with all relevant structural drawings and specifications.
 This drawing to be read in conjunction with all relevant mechanical and electrical drawings and specifications.
 All dimensions in millimeters. do not scale from this drawing. only use figured dimensions only.
 Contractor must verify all dimensions on site prior to installation of services and production of working drawings.

Notes:
 There shall be no deviations from the specifications of products specified during the tender process to ensure contractors are pricing on a like for like basis.
 Post tender, in the event that the contractor wishes to offer an alternative product to that specified, they shall submit full technical details of the product and full detailed lighting calculations for the alternative product.
 All costs associated with reviewing the alternative specifications shall be borne by the main contractor at an agreed rate prior to the exercise been carried out.
 In these specifications trade names and/or suppliers are used for the purpose of brevity and clarity of technical, aesthetic and functional intent.
 Such references are for the conveniences of the tenderer in clearly indicating the standard of technical, aesthetic and functional requirements sought by the specifier.
 The intention is not to favor one product over another or to eliminate other products/ suppliers.
 Other materials/suppliers may be put forward post tender for consideration as equivalent materials to those stated in the specification.
 Approval for substitution of equivalent materials/suppliers will be given where the alternative material/supplier are demonstrable equal in full accordance with the original specification.
 Equivalence of an offered substitution will be judged on the basis of objective, clear and verifiable independent proof of similar compliance with equal standards to those specified.
 Any increased costs arising whatsoever from such a substitution in terms of redesign, rescheduling, health and safety issues etc. shall be borne by the contractor.
 The contracting authority, through the consulting engineer who is the client representative, will determine on a case by case basis, from a technical, aesthetic and functional perspective, what constitutes an equivalent product.

P1	Issued for Planning	16/08/2024
Rev	Description	Date



Client: Limerick City & County Council

Architect: MGNE Architects
 23 Mountjoy Square
 Dublin 1

Project: Raheen Social Housing
 Ballycummin Road, Raheen,
 Limerick

Drawing: Electrical Installation
 Site Lighting

Proj Ref 23.2516	Drg Ref P-E100	Scale 1:200 A1
Drawn TK	Checked JM	Approved MF

Drawing Status:

Preliminary	<input type="checkbox"/> For Approval	<input checked="" type="checkbox"/> Tender Issue
For Information	<input type="checkbox"/> For Comment	<input type="checkbox"/> Contract Issue