

General Notes :

1. No part of this document may be re-produced or transmitted in any form or stored in any retrieval system without the written permission of the Consulting Engineer, David Kelly Partnership, as copyright holder except as agreed for use on the project for which the document was originally issued.
2. The contractor is responsible for checking all levels and dimensions on site and shall refer all discrepancies to the Engineer.
3. Only drawings issued for CONSTRUCTION shall be used for construction purposes.
4. Work to figured dimensions only. Do not scale print.
5. Check size of drawing sheet against dimension marks at bottom left hand corner of sheet.

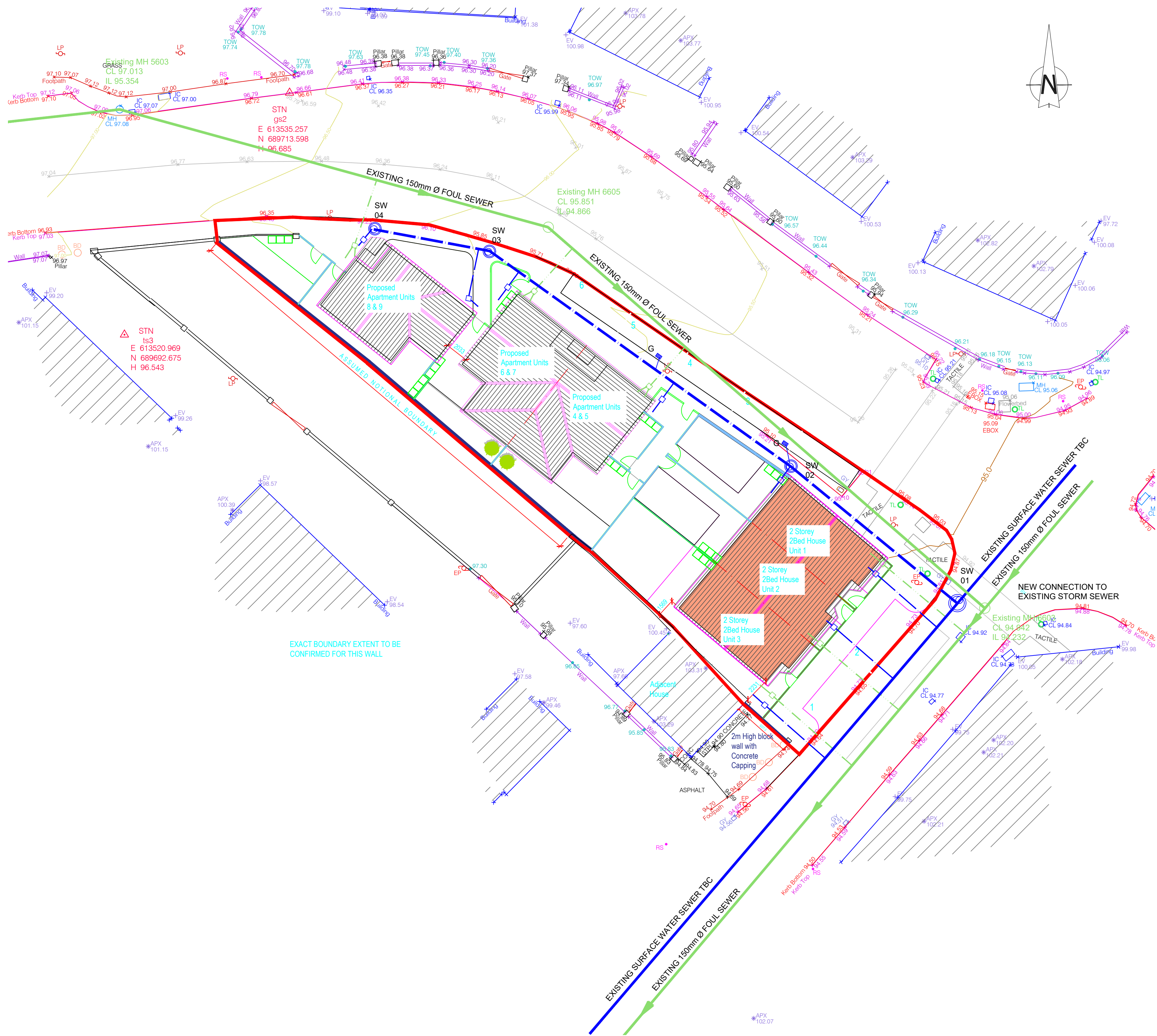

FOUL DRAINAGE NOTE:

FOUL WATER DRAINAGE INSTALLATION INCLUDING INDIVIDUAL HOUSE CONNECTIONS TO BE DESIGNED AND INSTALLED TO COMPLY WITH IRISH WATER CODE OF PRACTICE AND IRISH WATER STANDARD DETAILS.

FOUL WATER SEWER TO BE 150mm Ø uPVC SN8

INDIVIDUAL FOUL WATER HOUSE CONNECTIONS TO BE 100mm Ø uPVC PIPE

HYDRAULIC DESIGN TO COMPLY WITH CLAUSE 3.6 OF IW-CDS-5030-03, AND IN PARTICULAR CL. 3.6.5 & 3.6.6

LEAN MIX CONCRETE PROTECTION SLABS TO BE PROVIDED TO SEWERS WITH COVER LESS THAN 1.2m UNDER ROADS.

STORM WATER DRAINAGE NOTE:

INDIVIDUAL STORM WATER HOUSE CONNECTIONS TO BE 100mm Ø uPVC PIPE

STORM WATER GULLY CONNECTIONS TO BE 150mm Ø uPVC PIPE

STORM WATER SEWER PIPE TO BE 225mm uPVC PIPE

ALL SEWER PIPES TO BE uPVC COMPLY WITH IS EN1401 2009/2012 "UD" STIFFNESS CLASS 8kN/m²

LEGEND:

- EXISTING 150mm Ø CONC FOUL SEWER
- PROPOSED 100mm Ø PVC FOUL SEWER CONNECTION
- EXISTING STORMWATER SEWER
- PROPOSED 225mm Ø PVC STORMWATER SEWER
- P.C. ROAD GULLEY

Rev :	Note :
P4	ISSUED FOR PART 8 PLANNING APPLIC.
Date :	20 JAN. '23
Drawn :	
Approved :	DOS
Rev :	Note :
P3	ISSUED FOR PART 8 PLANNING APPLIC.
Date :	07 OCT. '22
Drawn :	
Approved :	DOS
Rev :	Note :
P2	ISSUED FOR PART 8 PLANNING APPLIC.
Date :	16 SEPT. '22
Drawn :	
Approved :	DOS
Rev :	Note :
P1	ISSUED FOR PART 8 PLANNING APPLIC.
Date :	20 OCT. '21
Drawn :	
Approved :	DOS



Nelson House, Emmet Place, | 10 Ormonde Street,
Youghal, Co. Cork. | Kilkenny.
t. +353 (0)24 92412 | t. +353 (0)56 7801260
e. info@dkp.ie | www.dkp.ie

Project :
TIPPERARY COUNTY COUNCIL
RESIDENTIAL DEVELOPMENT AT
GROVE STREET, ROSCREA, CO. TIPPERARY
ARCHITECT: C.J.FALCONER & ASSOCIATES

Title :
PROPOSED DRAINAGE LAYOUT

Purpose of Issue : PART 8 PLANNING		Scale : 1:200	
Project No. : 21049	Drawing No. : 102	Issue No. : P4	