

NOTES

- POLE TOP LUMINAIRES INSTALLED COMPLETE WITH INTEGRAL PHOTOCELL.
- LIGHTING CABLED IN 3 X 6.0MMSQ XLPE/SWA/PVC/Cu CABLE RATED FOR USE IN DUCTS
- LUMINAIRES SHALL BE SWITCHED THROUGH INTEGRAL PHOTOCELL IN EACH LUMINAIRE
- THE ELECTRICAL CONTRACTOR SHALL SUPPLY, INSTALL, TEST AND COMMISSION ALL LIGHTING POLES, POLE TOP LUMINAIRES, POLE CUT-OUTS AND SUNDRY ITEMS
- ALL ELECTRICAL WORKS SHALL BE CARRIED OUT IN STRICT ACCORDANCE WITH IS10101:2020 NATIONAL RULES FOR ELECTRICAL INSTALLATIONS 4TH EDITION.
- THE CONTRACTOR SHALL EMPLOY THE SERVICES OF A SPECIALIST STREET LIGHTING CONTRACTOR TO CARRY OUT THE SUPPLY AND INSTALLATION, TESTING, INSPECTION, COMMISSIONING AND HANDOVER OF THE STREET LIGHTING.
- THE SPECIALIST STREET LIGHTING CONTRACTOR SHALL BE APPROVED BY LIMERICK CITY AND COUNTY COUNCIL.
- THIS IS A LAYOUT DRAWING. DO NOT SCALE FROM THIS DRAWING, USE ARCHITECTS DRAWINGS TO TAKE FIGURED DIMENSIONS. ACTUAL DIMENSIONS SHOULD BE MEASURED BY MEANS OF A SITE VISIT.
- DESIGN AND INSTALLATION SHALL BE CARRIED OUT IN STRICT ACCORDANCE WITH LIMERICK CITY AND COUNTY COUNCILS STREET LIGHTING POLICY

- PROPOSED PUBLIC LIGHTING DUCTING ROUTE (230V Supply) 50MM RED IN COLOUR
- PROPOSED ESB DUCT FROM MINIPILLAR DUCTING ROUTE 50MM RED IN COLOUR

- MP** MINIPILLAR
 - MP** MICROPILLAR (STREET LIGHTING)
 - STREET LIGHT LOCATION
- Key**
- Luminaire A Column
 - Beam Aiming Target
 - Photometric Centre

Luminaire Data
 Luminaire A MPG-1N-30W
 MICROPLUS GERMANY 4000K 4500lm

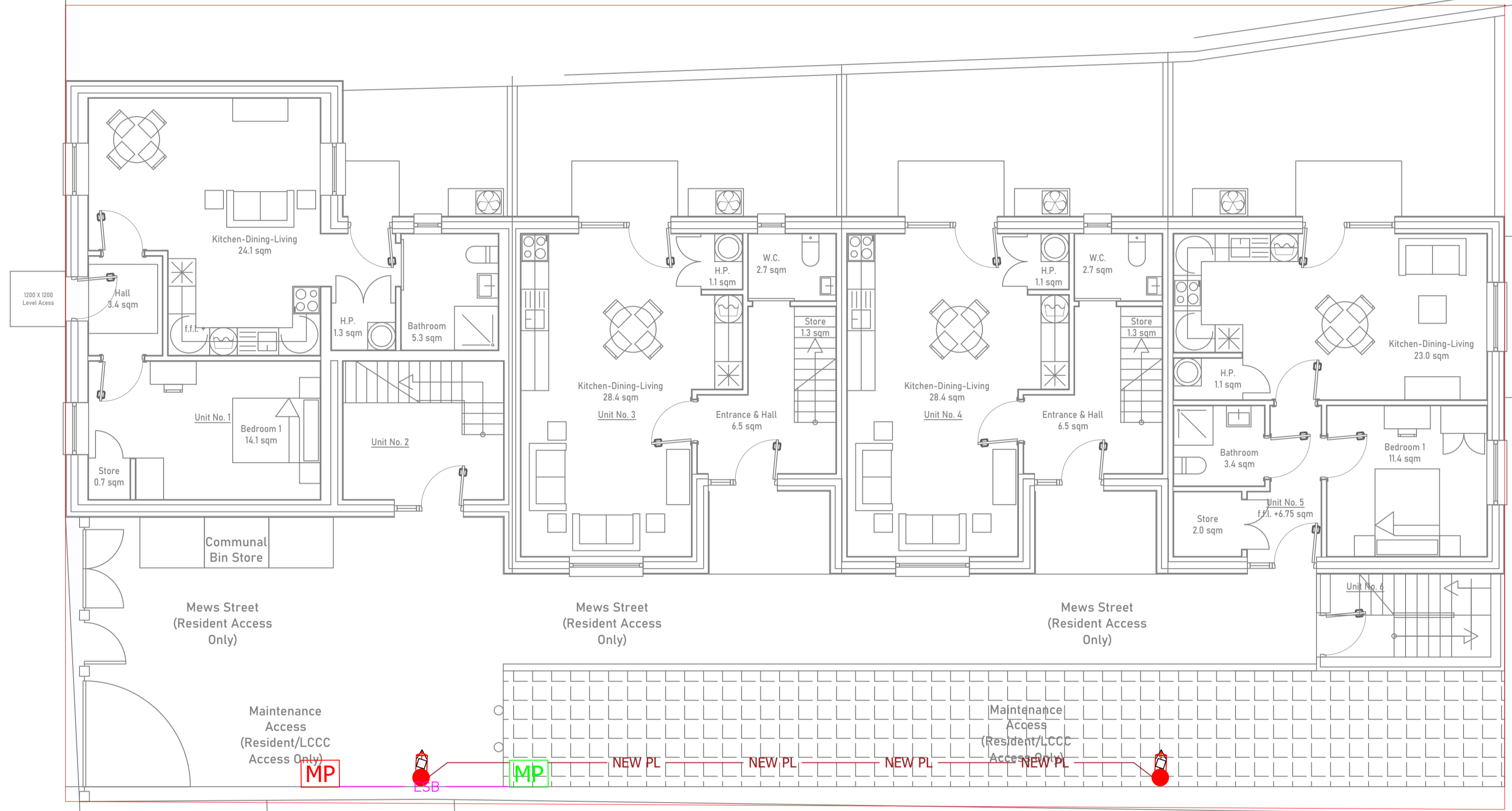
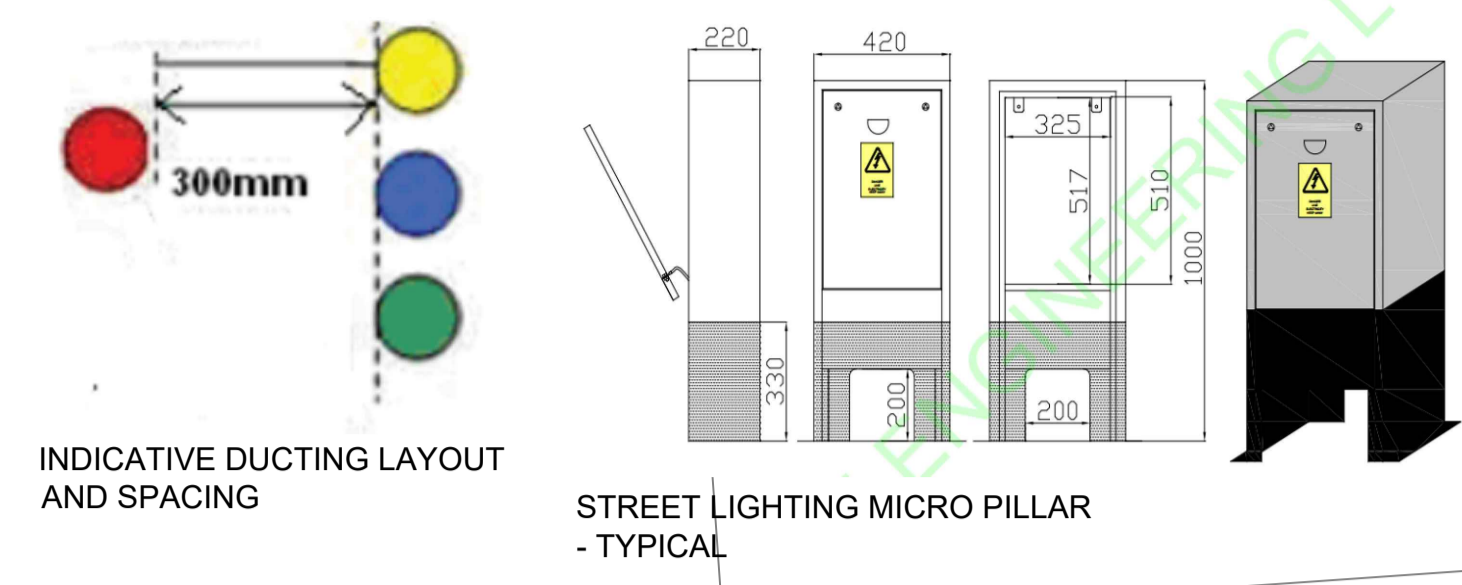

P	Preliminary	RY	05.07.24
REV:	DESCRIPTION:	BY:	DATE:
STATUS:			

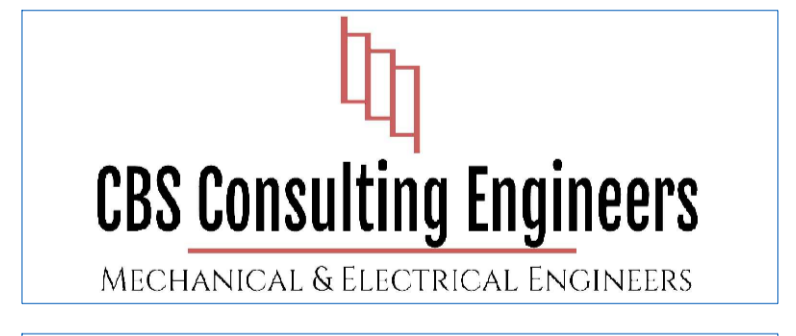

SITE:		52 New Road Thomondgate, Limerick	
TITLE: Roadway Lighting & Ducting Design			
SCALE AT A1:	DATE:	DRAWN:	CHECKED:
1:75	24.06.24	RY	RY
PROJECT NO:	DRAWING NO:	REVISION:	
	E800	P	

