

- LEGEND:**
- Existing French Drain
  - Existing Open Drain
  - Existing Carrier Drain
  - Existing Manhole
  - Proposed Filter Drain
  - Proposed Open Drain
  - Proposed Carrier Drain
  - Proposed Manhole
  - Proposed Road Gully
  - Proposed Soakway
  - Over the Edge Drainage to CC-SCD-00105
  - Existing Pavement Footprint
  - New Pavement Footprint

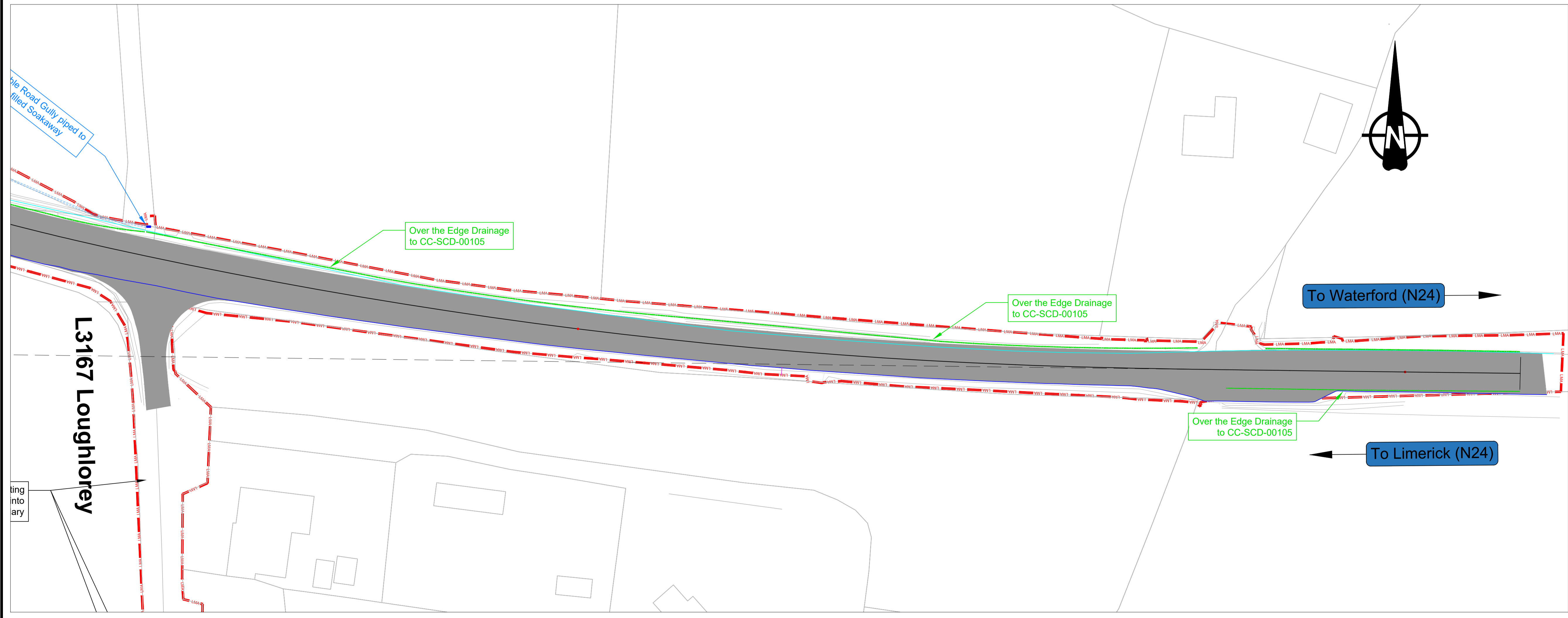

© Ordnance Survey Ireland. All rights reserved. Licence number: 2023/10/CCMA/TipperaryCountyCouncil.

NO.	Initials	Date	Description
C	PR	14-04-2023	PART 8 APPLICATION
B	LF	06-4-22	PRELIMINARY DESIGN
A	LF	21-7-20	PRELIMINARY DESIGN

**Scheme :-**  
N24 KNOCKAGH PAVEMENT IMPROVEMENT SCHEME

**Drawing title :-**  
DRAINAGE  
(SHEET 2 OF 2)

**Director Of Services :-**  
MARCUS O'CONNOR  
**Senior Engineer :-**  
JOHN NOLAN

<b>Drawn By :-</b> E.S.	<b>Designed By :-</b> O.T./E.S.
<b>Surveyed By :-</b> OS Detail & iGeomatics	<b>Checked By :-</b> L.F./O.T.
<b>Scale :-</b> 1: 500	<b>Date :-</b> JULY 2022

**Drawing No. :-**  
N24-KNOCKAGH-500-002  
**Drawing Path :-**  
T:\Groups\Roads Capital\PI\P1007N24KNOCKAGH\0607 PDR REPORT