

# Submission Details

## Submitter

Name	Eoin O'Shea
Address	PM, Design & Construction, Capital Investments, Network Enhancements Section Iarnród Éireann Irish Rail CIÉ Works, Inchicore Dublin 8 D08 K6Y3
Note	Iarnród Éireann Irish Rail submission incl. drawing requesting 2no. accessible parking spaces, provision for potential future entrance location, consideration to be given to pedestrians and cyclists and to pedestrians access from Sarsfield Gardens.

## In relation to application

Application Number	PT8LL93
Applicant Name	Limerick City and County Council
Development Address	Moyross Avenue Moyross



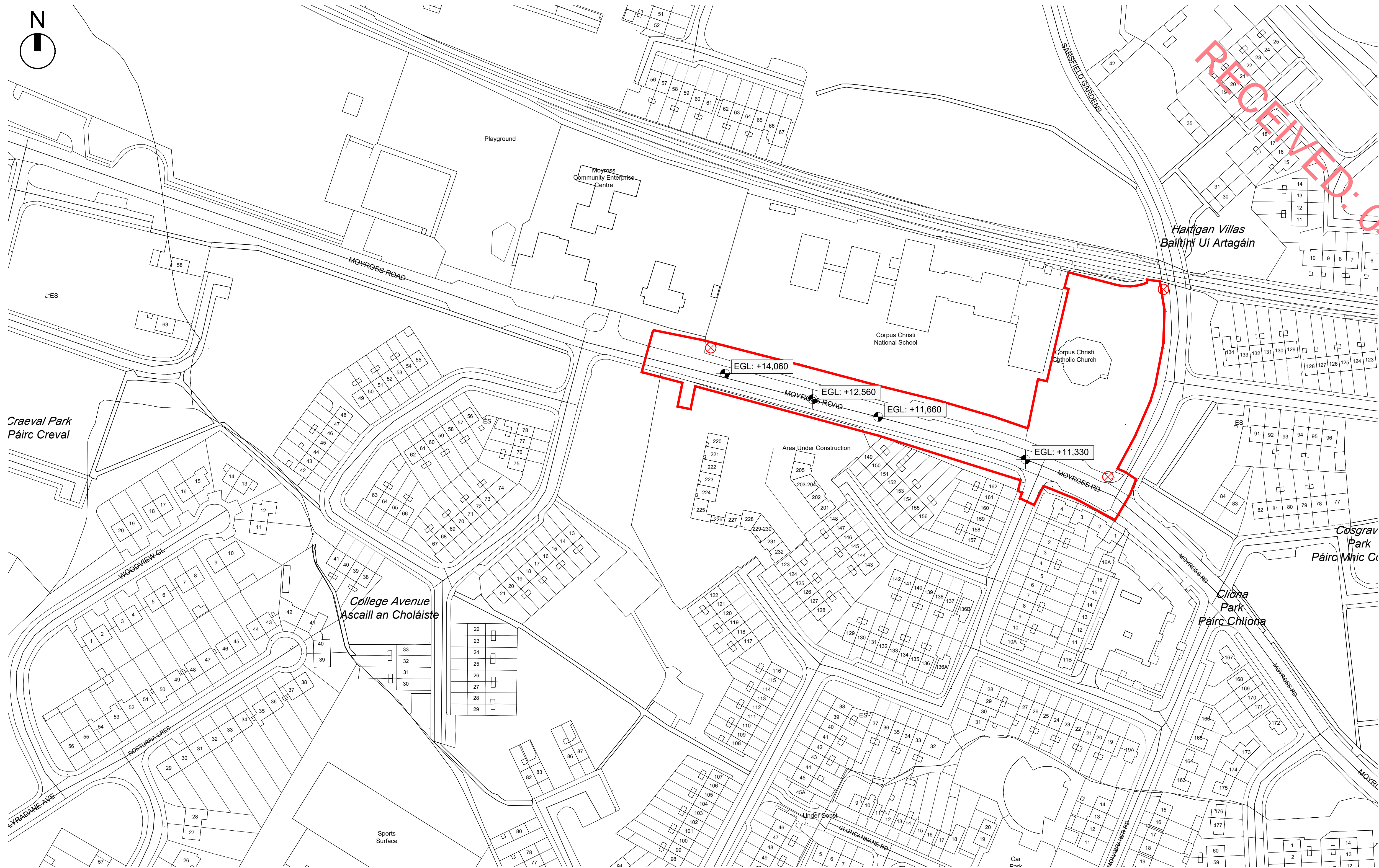
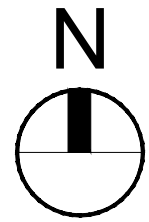

RECEIVED: 04/04/2024

A1.OS.1  
01 Site Location Map  
1:1,000 @ A1

0 10m 50m  
5m 20m 100m

**LEGEND**

Extent of Site Boundary  
Outlined Thus

Position of Site Notion  
Indicated Thus

**NOTES**

This drawing has been prepared for the following purpose only:

It should not be used, nor information contained therein be relied upon, for any other purpose whatsoever.

All drawings to be read in conjunction with all other related documents and other consultants drawings and documentation. Architects to be informed immediately of any discrepancies before work proceeds.

**© COPYRIGHT**

This drawing and any design hereon is copyright of **Deaton Lysaght Architects** and must not be reproduced in whole or in part without their express written consent.

**DIMENSIONS**

Figured dimensions only to be taken from this drawing. All dimensions to be checked on site. Architects to be informed immediately of any discrepancies before work proceeds.

Revisions:		
No:	Revision:	Date:
A	For Part 8	2024.02.19
B	For Part 8	2024.02.20
C	For Part 8	2024.02.21

**Specification:**

**Comhairle Cathrach  
& Contae Luimnigh**

**Limerick City  
& County Council**

**Project:**  
Moyross Avenue  
Realignment at School

**Client:**  
Limerick City & County Council

**Drawing Title:**  
Site Location Map

Scale:	Drawing No.:	Rev:
As Shown	<b>CPP4 - A1.OS.1</b>	*
Drawn by:	Checked by:	Date:
SF		21-Feb-24

<b>DEATON LYSAGHT ARCHITECTS</b> 44 SOUTH RICHMOND STREET, DUBLIN 5, D02 T284 Tel: 353 1 4754960 mail@deatonlysaght.ie www.deatonlysaght.ie	<b>JFOC ARCHITECTS</b> 314 GREENMOUNT HOUSE HARDUP'S CROSS DUBLIN 6W D06 X008 Tel: 353 1 453 0277 info@jfocarchitects.com www.jfocarchitects.com
---	---



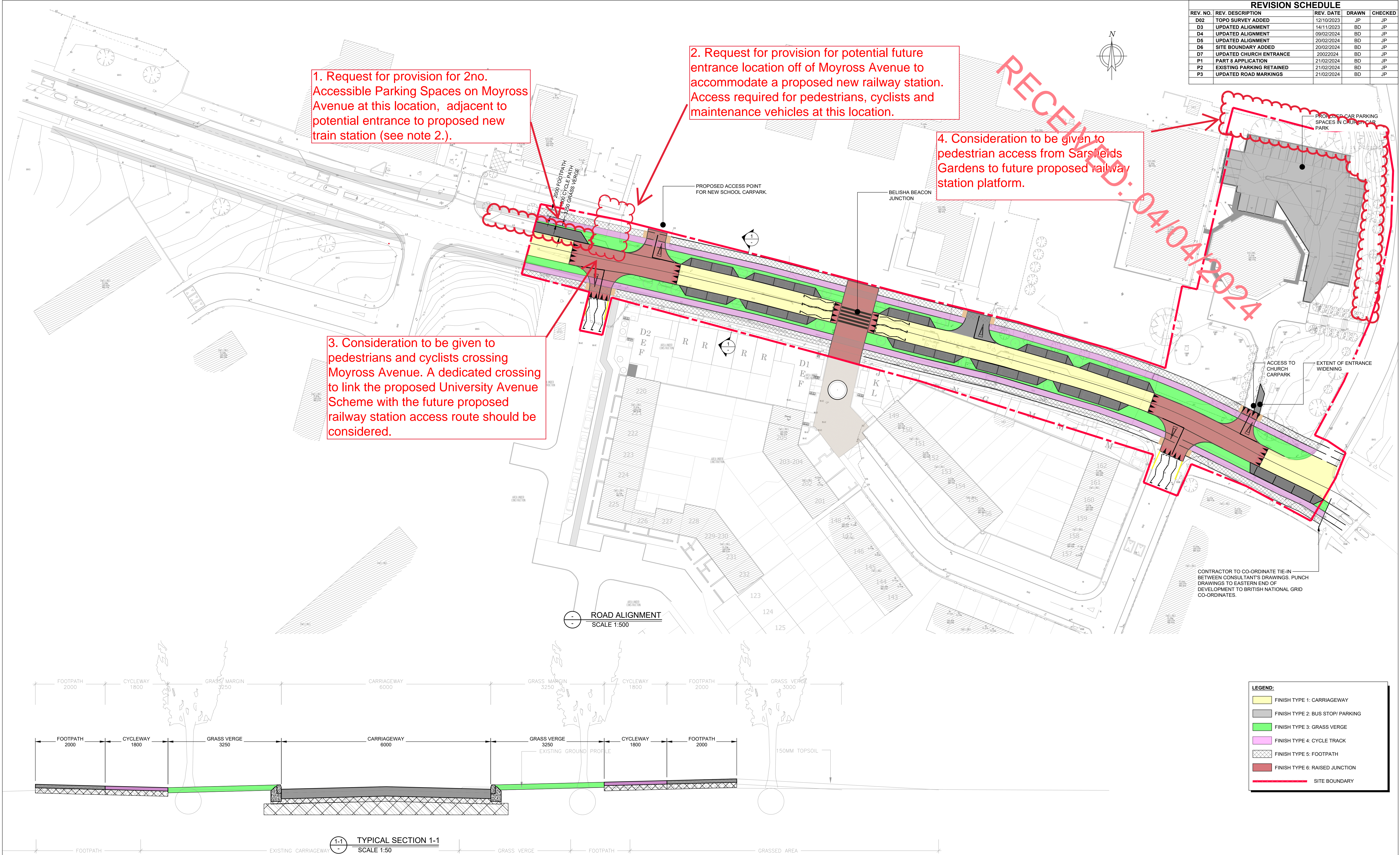

REVISION SCHEDULE				
REV. NO.	REV. DESCRIPTION	REV. DATE	DRAWN	CHECKED
D02	TOPO SURVEY ADDED	12/10/2023	JP	JP
D3	UPDATED ALIGNMENT	14/11/2023	BD	JP
D4	UPDATED ALIGNMENT	09/02/2024	BD	JP
D5	UPDATED ALIGNMENT	20/02/2024	BD	JP
D6	SITE BOUNDARY ADDED	20/02/2024	BD	JP
D7	UPDATED CHURCH ENTRANCE	20/02/2024	BD	JP
P1	PART 8 APPLICATION	21/02/2024	BD	JP
P2	EXISTING PARKING RETAINED	21/02/2024	BD	JP
P3	UPDATED ROAD MARKINGS	21/02/2024	BD	JP

Drawing Stage:  PART 8 APPLICATION	Project Details:		Notes										Drawn by:		Checked by:		Approved by:		Date:		<div><div><div>CORA</div><div>CONSULTING ENGINEERS</div></div><div>Behan House, 10 Lower Mount Street, Dublin 2. D02 HT71 Tel: +353 1 661 1100 e-mail: info@cora.ie Web: www.cora.ie</div></div>									
	Site Address:	CLIONA PARK, MOYROSS, Co. LIMERICK											JP		JP		JP		10/10/2023											
	Client:	LIMERICK CITY AND COUNTY COUNCIL	Project Name:						Scale:		Project Number:																			
	Architect:	DEATON LYSAGHT ARCHITECTS	CLIONA PARK - PHASE 4						1:500 @ A1		2323																			
	M&E Designer:	RENAISSANCE ENGINEERING Ltd.	Drawing Title:						Project:		Originator:	Zone:	Level:	Type:	Discipline:	Drawing No:	Stage:	Revision:												
	Contractor:	-	ROAD ALIGNMENT GENERAL ARRANGEMENT						-		CORA	-	-	DR	C	101	P	03												