

© CST Group
 This drawing and any design herein is the copyright of the
 Consultants and must not be reproduced without written consent.
 All drawings remain the property of the Consultants.
 Figure dimension only to be taken from this drawing.
 All dimensions to be checked on site.
 Consultants to be informed immediately of any
 discrepancies before work proceeds.
 © Ordnance Survey Ireland Government of Ireland
 Ordnance Survey Ireland Licence Number CYAL50369672

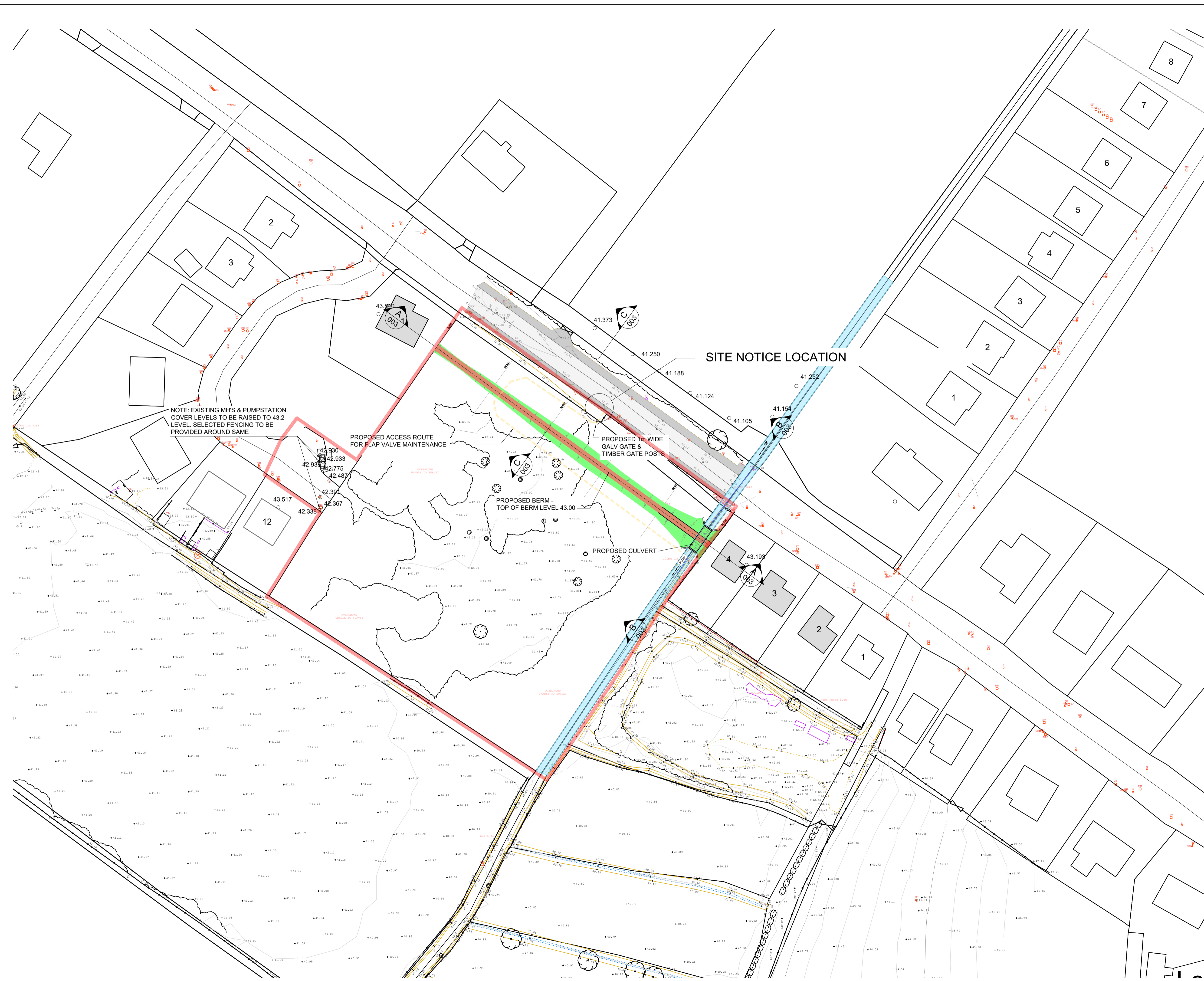
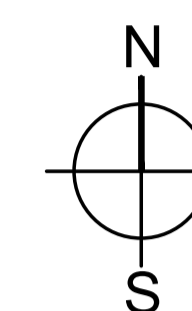

NOTE: EXISTING MHS & PUMPSTATION
 COVER LEVELS TO BE RAISED TO 43.2
 LEVEL. SELECTED FENCING TO BE
 PROVIDED AROUND SAME

PROPOSED ACCESS ROUTE
 FOR FLAP VALVE MAINTENANCE

PROPOSED 1m WIDE
 GALV GATE &
 TIMBER GATE POSTS

PROPOSED BERM -
 TOP OF BERM LEVEL 43.00

PROPOSED CULVERT

LEGEND

- EXISTING RIVER
- EXISTING FENCE
- EXISTING MASONRY ARCH BRIDGE PARAPET
- EXISTING TREES / BRUSH / FOLIAGE
- EXISTING LEVELS
- PROPOSED CULVERT
- PROPOSED BERM SLOPES
- PROPOSED TOP OF BERM (FLAT)
- PROPOSED ACCESS ROUTE FOR FLAP VALVE MAINTENANCE
- SITE BOUNDARY

REV.	AMENDMENT	BY	DATE

DRAWN: ST	TECH. CHECK: ST
SCALE @ A1: 1:500	ENG. CHECK: SS
DATE: 21/12/23	APPROVED: C.O'C
STAGE: PLANNING	

JOB TITLE: KEADUE ROAD, FLOOD DEFENCE BERM,
 LEITRIM VILLAGE, Co LEITRIM

DRAWING TITLE: SITE LAYOUT

CLIENT: LEITRIM COUNTY COUNCIL

DRAWING NO: 123-196-001 REV: PO

CST Group
 Chartered Consulting Engineers

1, O'CONNELL ST.
 SLIGO
 F91 W7V
 IRELAND
 +353 71 919 4500
 info@cstgroup.ie
 www.cstgroup.ie