

Unit 6  
Belturbet Business Park  
Creeny  
Belturbet  
Co. Cavan  
H14AY94

T: +353 49 9522236  
E: info@alantraynor.com  
W: www.alantraynor.com

2nd Floor  
67-70  
Meath St  
Dublin 8  
D08XY53

T: +353 1 6750850  
E: dublin@alantraynor.com  
W: www.alantraynor.com



**Alan Traynor**  
Consulting Engineers Ltd.



## **Alan Traynor Consulting Engineers Ltd**

### **LEITRIM COUNTY COUNCIL**

Proposed Development at Sean Mac Diarmada Street,  
Manorhamilton, Co Leitrim

Foul, Surface Water, Water Supply,  
& Calculations





## Table of Contents

1.0	Introduction .....	2
1.1	Site Description .....	2
2.0	Surface Water Drainage.....	2
2.1	Surface Water Drainage - Existing.....	2
2.2	Surface Water Drainage – Proposed .....	2
3.0	Foul Drainage .....	2
3.1	Foul Drainage – Existing.....	2
3.2	Foul Drainage – Proposed.....	3
4.0	Water Supply.....	3
4.1	Water Supply – Existing .....	3
4.2	Water Supply - Proposed .....	3

### **Appendix A – CCTV Report**

### **Appendix B – Irish Water Application for Confirmation of Feasibility**



## 1.0 Introduction

Alan Traynor Consulting Engineers Ltd has been engaged by Leitrim County Council to carry out engineering services design for a proposed residential development located at Sean Mac Diarmada Street, Manorhamilton, Co. Leitrim. This report addresses the foul drainage, surface water drainage and water supply for this application.

### 1.1 Site Description

The site has an approximate area of 0.0147 hectares and is located along Sean Mac Diarmada Street, Manorhamilton, Co. Leitrim. The site currently has 2 No. residential units located on it. The site can be accessed off Sean Mac Diarmada Street.

## 2.0 Surface Water Drainage

### 2.1 Surface Water Drainage - Existing

There is a storm sewer located on Sean Mac Diarmada Street of the proposed development. The location and depth of this sewer has yet to be identified. A GPR Scan will be carried out to establish this.

### 2.2 Surface Water Drainage – Proposed

We propose to install a new Surface Water network on site to collect roof and paved area. It is proposed to make a new connection to the existing network on Sean Mac Diarmada Street. Please refer to drawing 23-240-100 for the storm sewer layout.

## 3.0 Foul Drainage

### 3.1 Foul Drainage – Existing

There is an existing 100mm foul sewer to the rear of the site servicing the existing dwellings. A CCTV of this sewer has been carried out. There are a few minor defects to be remediated prior to the new units being constructed. Please refer to Appendix A for a copy of the CCTV.



### 3.2 Foul Drainage – Proposed

All 4 units will be collected by means of 100mm pipes and discharge to a proposed new manhole to the rear of the property on the existing 100mm pipe.

## 4.0 Water Supply

### 4.1 Water Supply – Existing

There is an existing water main located in Sean Mac Diarmada Street. There is 1 No. existing connections to this water main which services the existing dwellings on site. It is proposed to reuse this connection for the proposed development.

### 4.2 Water Supply - Proposed

It is proposed to make 3 No. new 25mm connections to the existing water main located in the road to service the 2 No additional units. Please refer to Appendix B for a copy of the Confirmation of Feasibility Application to Irish Water.

Appendix A  
CCTV Report

**Project**

**Project Name:** J-035641 Alan Traynor Eng Ltd- Manorhamilton

**Project Description:** CCTV Survey

**Project Number:** J-035641

**Project Status:** Complete

**Project Date:** 03/01/2023

## Table of Contents

Project Name	Project Number	Project Date
J-035641 Alan Traynor Eng Ltd- Manorhamilton	J-035641	03/01/2023

Project Information .....	P-1
Section Item 1: MH1 > MH2 (MH1X) .....	1
Section Item 2: MH1 > UPS2 (MH1X) .....	2
Section Item 3: MH1 > DS (MH1X) .....	4
Section Item 4: MH1 > UPS1 (MH1X) .....	5
Section Item 5: MH2 > UPS5 (MH2X) .....	6
Section Item 6: MH2 > UPS4 (MH2X) .....	8
Section Item 7: UPS3 > MH2 (UPS3X) .....	9

**Project Information**

Project Name	Project Number	Project Date
J-035641 Alan Traynor Eng Ltd- Manorhamilton	J-035641	03/01/2023

**Client**

**Company:** Alan Traynor Consulting Engineers Ltd  
**Contact:** Marc Bride  
**Street:** Holborn Hill  
**Town or City:** Belturbet  
**County:** County Cavan

**Manager**

**Contact:** Marc  
**Town or City:** Manorhamilton  
**County:** Co. Leitrim

**Contractor**

**Company:** McBreen Environmental  
**Contact:** CCTV Department  
**Street:** Lismagratty  
**Town or City:** Cootehill Road  
**County:** Cavan  
**Phone:** 0494380170  
**Email:** info@mcbreen.ie





### Section Inspection - 15/12/2022 - MH1X

Item No. 1	Insp. No. 4	Date 15/12/22	Time 9:21	Client's Job Ref J-035641	Weather No Rain Or Snow	Pre Cleaned Yes	PLR MH1X
Operator SEAN		Vehicle Not Specified		Camera Not Specified	Preset Length Not Specified	Legal Status Not Specified	Alternative ID 1

Town or Village:	Manorhamilton	Inspection Direction:	Upstream	Upstream Node:	MH1
Road:	Sean Mcdermot St	Inspected Length:	3.42 m	Upstream Pipe Depth:	
Location:	Gardens (private)	Total Length:	3.42 m	Downstream Node:	MH2
Surface Type:		Joint Length:		Downstream Pipe Depth:	
Use:	Combined	Pipe Shape:	Circular		
Type of Pipe:	Gravity drain/sewer	Dia/Height:	100 mm		
Flow Control:	No flow control	Pipe Material:	Polyvinyl chloride		
Year Constructed:	Not Specified	Lining Type:	No Lining		
Inspection Purpose:	Routine inspection	Lining Material:	No Lining		

**Comments:**  
**Recommendations:**

Scale:	1:50	Position [m]	Code	Observation	MPEG	Photo	Grade
		Depth: m MH2					
		0.00	MH	Start node, manhole, reference: MH2	00:00:00		
		0.00	WL	Water level, 5% of the vertical dimension	00:00:01		
		3.42	MHF	Finish node, manhole, reference: MH1	00:00:25		
		Depth: m MH1					



Construction Features					Miscellaneous Features				
Structural Defects					Service & Operational Observations				
STR No. Def	STR Peak	STR Mean	STR Total	STR Grade	SER No. Def	SER Peak	SER Mean	SER Total	SER Grade
0	0.0	0.0	0.0	1.0	0	0.0	0.0	0.0	1.0

### Section Inspection - 15/12/2022 - MH1X

Item No. 2	Insp. No. 3	Date 15/12/22	Time 9:19	Client's Job Ref J-035641	Weather No Rain Or Snow	Pre Cleaned Yes	PLR MH1X
Operator SEAN		Vehicle Not Specified		Camera Not Specified	Preset Length Not Specified	Legal Status Not Specified	Alternative ID 1

Town or Village:	Manorhamilton	Inspection Direction:	Upstream	Upstream Node:	MH1
Road:	Sean Mcdermot St	Inspected Length:	3.03 m	Upstream Pipe Depth:	
Location:	Gardens (private)	Total Length:	3.03 m	Downstream Node:	UPS2
Surface Type:		Joint Length:		Downstream Pipe Depth:	
Use:	Combined	Pipe Shape:	Circular		
Type of Pipe:	Gravity drain/sewer	Dia/Height:	100 mm		
Flow Control:	No flow control	Pipe Material:	Polyvinyl chloride		
Year Constructed:	Not Specified	Lining Type:	No Lining		
Inspection Purpose:	Routine inspection	Lining Material:	No Lining		

**Comments:**  
**Recommendations:**

Scale:	1:50	Position [m]	Code	Observation	MPEG	Photo	Grade
		Depth: m UPS2					
		0.00	MH	Start node, manhole, reference: UPS2	00:00:00		
		0.00	WL	Water level, 5% of the vertical dimension	00:00:00		
		1.82	LL	Line deviates left	00:00:15		
		1.98	JDM	Joint displaced, medium	00:00:23	MH1 TO UPS2_1-9 8m_09204	1 / 3
		3.03	LU	Line deviates up	00:00:29		
		3.03	MHF	Finish node, manhole, reference: MH1	00:00:30		
		MH1 Depth: m					

Construction Features					Miscellaneous Features				
Structural Defects					Service & Operational Observations				
STR No. Def	STR Peak	STR Mean	STR Total	STR Grade	SER No. Def	SER Peak	SER Mean	SER Total	SER Grade
1	1.0	0.3	1.0	1.0	1	2.0	0.7	2.0	3.0

**Section Pictures - 15/12/2022 - MH1X**

Item No.	Inspection Direction	PLR	Client's Job Ref	Contractor's Job Ref
2	Upstream	MH1X	J-035641	McBreen



MH1 TO UPS2\_1-98m\_092041.jpg, 00:00:23, 1.98 m  
Joint displaced, medium

### Section Inspection - 15/12/2022 - MH1X

Item No. 3	Insp. No. 1	Date 15/12/22	Time 9:07	Client's Job Ref J-035641	Weather No Rain Or Snow	Pre Cleaned Yes	PLR MH1X
Operator SEAN		Vehicle Not Specified		Camera Not Specified	Preset Length Not Specified	Legal Status Not Specified	Alternative ID 1

Town or Village:	Manorhamilton	Inspection Direction:	Downstream	Upstream Node:	MH1
Road:	Sean Mcdermot St	Inspected Length:	42.66 m	Upstream Pipe Depth:	
Location:	Gardens (private)	Total Length:	42.66 m	Downstream Node:	DS
Surface Type:		Joint Length:		Downstream Pipe Depth:	
Use:	Combined	Pipe Shape:	Circular		
Type of Pipe:	Gravity drain/sewer	Dia/Height:	100 mm		
Flow Control:	No flow control	Pipe Material:	Polyvinyl chloride		
Year Constructed:	Not Specified	Lining Type:	No Lining		
Inspection Purpose:	Routine inspection	Lining Material:	No Lining		

**Comments:**  
**Recommendations:**

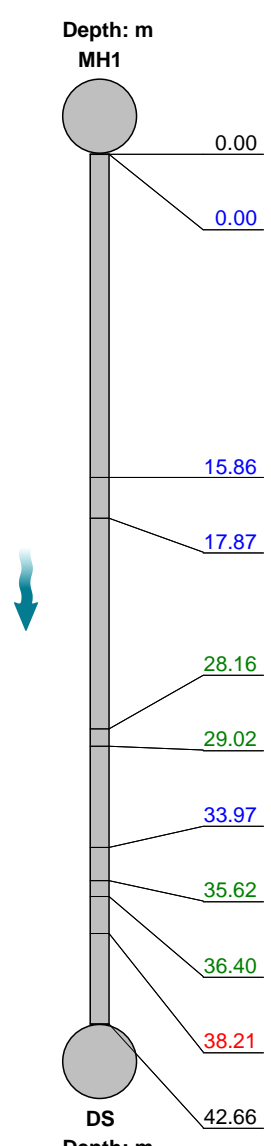
Scale:	1:370	Position [m]	Code	Observation	MPEG	Photo	Grade																																																																		
<div style="display: flex; align-items: center;"> <div style="flex: 1;"> <p style="text-align: center;">Depth: m MH1</p>  <p style="text-align: center;">DS Depth: m</p> </div> <table border="1" style="width: 100%; border-collapse: collapse;"> <tr> <td style="text-align: right;">0.00</td> <td style="text-align: center;">MH</td> <td>Start node, manhole, reference: MH1</td> <td style="text-align: right;">00:00:00</td> <td></td> <td></td> </tr> <tr> <td style="text-align: right;">0.00</td> <td style="text-align: center;">WL</td> <td>Water level, 5% of the vertical dimension</td> <td style="text-align: right;">00:00:00</td> <td></td> <td></td> </tr> <tr> <td style="text-align: right;">15.86</td> <td style="text-align: center;">WL</td> <td>Water level, 10% of the vertical dimension</td> <td style="text-align: right;">00:00:49</td> <td></td> <td></td> </tr> <tr> <td style="text-align: right;">17.87</td> <td style="text-align: center;">WL</td> <td>Water level, 5% of the vertical dimension</td> <td style="text-align: right;">00:00:56</td> <td></td> <td></td> </tr> <tr> <td style="text-align: right;">28.16</td> <td style="text-align: center;">LR</td> <td>Line deviates right: MANHOLE</td> <td style="text-align: right;">00:01:26</td> <td></td> <td></td> </tr> <tr> <td style="text-align: right;">29.02</td> <td style="text-align: center;">LR</td> <td>Line deviates right</td> <td style="text-align: right;">00:01:34</td> <td></td> <td></td> </tr> <tr> <td style="text-align: right;">33.97</td> <td style="text-align: center;">WL</td> <td>Water level, 10% of the vertical dimension</td> <td style="text-align: right;">00:01:49</td> <td></td> <td></td> </tr> <tr> <td style="text-align: right;">35.62</td> <td style="text-align: center;">LL</td> <td>Line deviates left: MANHOLE</td> <td style="text-align: right;">00:01:57</td> <td></td> <td></td> </tr> <tr> <td style="text-align: right;">36.40</td> <td style="text-align: center;">LL</td> <td>Line deviates left</td> <td style="text-align: right;">00:02:05</td> <td></td> <td></td> </tr> <tr> <td style="text-align: right;">38.21</td> <td style="text-align: center;">D</td> <td>Deformed sewer or drain, 5%</td> <td style="text-align: right;">00:02:20</td> <td></td> <td style="text-align: right;">1 / 2</td> </tr> <tr> <td style="text-align: right;">42.66</td> <td style="text-align: center;">MHF</td> <td>Finish node, manhole, reference: DS</td> <td style="text-align: right;">00:02:51</td> <td></td> <td></td> </tr> </table> </div>								0.00	MH	Start node, manhole, reference: MH1	00:00:00			0.00	WL	Water level, 5% of the vertical dimension	00:00:00			15.86	WL	Water level, 10% of the vertical dimension	00:00:49			17.87	WL	Water level, 5% of the vertical dimension	00:00:56			28.16	LR	Line deviates right: MANHOLE	00:01:26			29.02	LR	Line deviates right	00:01:34			33.97	WL	Water level, 10% of the vertical dimension	00:01:49			35.62	LL	Line deviates left: MANHOLE	00:01:57			36.40	LL	Line deviates left	00:02:05			38.21	D	Deformed sewer or drain, 5%	00:02:20		1 / 2	42.66	MHF	Finish node, manhole, reference: DS	00:02:51		
0.00	MH	Start node, manhole, reference: MH1	00:00:00																																																																						
0.00	WL	Water level, 5% of the vertical dimension	00:00:00																																																																						
15.86	WL	Water level, 10% of the vertical dimension	00:00:49																																																																						
17.87	WL	Water level, 5% of the vertical dimension	00:00:56																																																																						
28.16	LR	Line deviates right: MANHOLE	00:01:26																																																																						
29.02	LR	Line deviates right	00:01:34																																																																						
33.97	WL	Water level, 10% of the vertical dimension	00:01:49																																																																						
35.62	LL	Line deviates left: MANHOLE	00:01:57																																																																						
36.40	LL	Line deviates left	00:02:05																																																																						
38.21	D	Deformed sewer or drain, 5%	00:02:20		1 / 2																																																																				
42.66	MHF	Finish node, manhole, reference: DS	00:02:51																																																																						

Construction Features					Miscellaneous Features				
Structural Defects					Service & Operational Observations				
STR No. Def	STR Peak	STR Mean	STR Total	STR Grade	SER No. Def	SER Peak	SER Mean	SER Total	SER Grade
1	0.0	0.0	0.0	1.0	1	1.0	0.0	1.0	2.0

### Section Inspection - 15/12/2022 - MH1X

Item No. 4	Insp. No. 2	Date 15/12/22	Time 9:18	Client's Job Ref J-035641	Weather No Rain Or Snow	Pre Cleaned Yes	PLR MH1X
Operator SEAN		Vehicle Not Specified		Camera Not Specified	Preset Length Not Specified	Legal Status Not Specified	Alternative ID 1

Town or Village:	Manorhamilton	Inspection Direction:	Upstream	Upstream Node:	MH1
Road:	Sean Mcdermot St	Inspected Length:	1.43 m	Upstream Pipe Depth:	
Location:	Gardens (private)	Total Length:	1.43 m	Downstream Node:	UPS1
Surface Type:		Joint Length:		Downstream Pipe Depth:	
Use:	Combined	Pipe Shape:	Circular		
Type of Pipe:	Gravity drain/sewer	Dia/Height:	100 mm		
Flow Control:	No flow control	Pipe Material:	Polyvinyl chloride		
Year Constructed:	Not Specified	Lining Type:	No Lining		
Inspection Purpose:	Routine inspection	Lining Material:	No Lining		

**Comments:**  
**Recommendations:**

Scale:	1:50	Position [m]	Code	Observation	MPEG	Photo	Grade
		Depth: m UPS1					
		0.00	MH	Start node, manhole, reference: UPS1	00:00:00		
		0.00	WL	Water level, 5% of the vertical dimension	00:00:00		
		1.43	LD	Line deviates down	00:00:09		
		1.43	MHF	Finish node, manhole, reference: MH1	00:00:10		
		MH1 Depth: m					

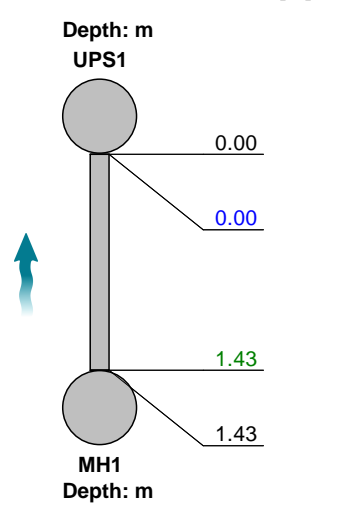

Construction Features					Miscellaneous Features				
Structural Defects					Service & Operational Observations				
STR No. Def	STR Peak	STR Mean	STR Total	STR Grade	SER No. Def	SER Peak	SER Mean	SER Total	SER Grade
0	0.0	0.0	0.0	1.0	0	0.0	0.0	0.0	1.0

### Section Inspection - 15/12/2022 - MH2X

Item No. 5	Insp. No. 7	Date 15/12/22	Time 9:29	Client's Job Ref J-035641	Weather No Rain Or Snow	Pre Cleaned Yes	PLR MH2X
Operator SEAN		Vehicle Not Specified		Camera Not Specified	Preset Length Not Specified	Legal Status Not Specified	Alternative ID 1

Town or Village:	Manorhamilton	Inspection Direction:	Upstream	Upstream Node:	MH2
Road:	Sean Mcdermot St	Inspected Length:	3.18 m	Upstream Pipe Depth:	
Location:	Gardens (private)	Total Length:	3.18 m	Downstream Node:	UPS5
Surface Type:		Joint Length:		Downstream Pipe Depth:	
Use:	Combined	Pipe Shape:	Circular		
Type of Pipe:	Gravity drain/sewer	Dia/Height:	100 mm		
Flow Control:	No flow control	Pipe Material:	Polyvinyl chloride		
Year Constructed:	Not Specified	Lining Type:	No Lining		
Inspection Purpose:	Routine inspection	Lining Material:	No Lining		

**Comments:**  
**Recommendations:**

Scale:	1:50	Position [m]	Code	Observation	MPEG	Photo	Grade
		Depth: m UPS5					
		0.00	MH	Start node, manhole, reference: UPS5	00:00:00		
		0.00	WL	Water level, 5% of the vertical dimension	00:00:01		
		1.30	JN	Junction at 12 o'clock, 100mm dia: MANHOLE	00:00:10	MH2 TO UPS5_1-3 0m_09312	
		3.18	LD	Line deviates down	00:00:27		
		3.18	MHF	Finish node, manhole, reference: MH2	00:00:28		
		Depth: m MH2					

Construction Features					Miscellaneous Features				
Structural Defects					Service & Operational Observations				
STR No. Def	STR Peak	STR Mean	STR Total	STR Grade	SER No. Def	SER Peak	SER Mean	SER Total	SER Grade
0	0.0	0.0	0.0	1.0	0	0.0	0.0	0.0	1.0

**Section Pictures - 15/12/2022 - MH2X**

Item No.	Inspection Direction	PLR	Client's Job Ref	Contractor's Job Ref
5	Upstream	MH2X	J-035641	McBreen



MH2 TO UPS5\_1-30m\_093121.jpg, 00:00:10, 1.30 m  
Junction at 12 o'clock, 100mm dia, MANHOLE

### Section Inspection - 15/12/2022 - MH2X

Item No. 6	Insp. No. 6	Date 15/12/22	Time 9:27	Client's Job Ref J-035641	Weather No Rain Or Snow	Pre Cleaned Yes	PLR MH2X
Operator SEAN		Vehicle Not Specified		Camera Not Specified	Preset Length Not Specified	Legal Status Not Specified	Alternative ID 1

Town or Village:	Manorhamilton	Inspection Direction:	Upstream	Upstream Node:	MH2
Road:	Sean Mcdermot St	Inspected Length:	1.13 m	Upstream Pipe Depth:	
Location:	Gardens (private)	Total Length:	1.13 m	Downstream Node:	UPS4
Surface Type:		Joint Length:		Downstream Pipe Depth:	
Use:	Combined	Pipe Shape:	Circular		
Type of Pipe:	Gravity drain/sewer	Dia/Height:	100 mm		
Flow Control:	No flow control	Pipe Material:	Polyvinyl chloride		
Year Constructed:	Not Specified	Lining Type:	No Lining		
Inspection Purpose:	Routine inspection	Lining Material:	No Lining		

**Comments:**  
**Recommendations:**

Scale:	1:50	Position [m]	Code	Observation	MPEG	Photo	Grade																																
<div style="display: flex; align-items: center;"> <div style="margin-right: 20px;"> <p>Depth: m</p> <p>UPS4</p>  <p>MH2</p> <p>Depth: m</p> </div> <table border="1" style="width: 100%; border-collapse: collapse;"> <tr> <td style="width: 15%; text-align: center;">0.00</td> <td style="width: 5%; text-align: center;">MH</td> <td style="width: 30%;">Start node, manhole, reference: UPS4</td> <td style="width: 10%; text-align: center;">00:00:00</td> <td colspan="4"></td> </tr> <tr> <td style="width: 15%; text-align: center;">0.00</td> <td style="width: 5%; text-align: center;">WL</td> <td style="width: 30%;">Water level, 5% of the vertical dimension</td> <td style="width: 10%; text-align: center;">00:00:00</td> <td colspan="4"></td> </tr> <tr> <td style="width: 15%; text-align: center;">1.13</td> <td style="width: 5%; text-align: center;">LU</td> <td style="width: 30%;">Line deviates up</td> <td style="width: 10%; text-align: center;">00:00:10</td> <td colspan="4"></td> </tr> <tr> <td style="width: 15%; text-align: center;">1.13</td> <td style="width: 5%; text-align: center;">MHF</td> <td style="width: 30%;">Finish node, manhole, reference: MH2</td> <td style="width: 10%; text-align: center;">00:00:10</td> <td colspan="4"></td> </tr> </table> </div>								0.00	MH	Start node, manhole, reference: UPS4	00:00:00					0.00	WL	Water level, 5% of the vertical dimension	00:00:00					1.13	LU	Line deviates up	00:00:10					1.13	MHF	Finish node, manhole, reference: MH2	00:00:10				
0.00	MH	Start node, manhole, reference: UPS4	00:00:00																																				
0.00	WL	Water level, 5% of the vertical dimension	00:00:00																																				
1.13	LU	Line deviates up	00:00:10																																				
1.13	MHF	Finish node, manhole, reference: MH2	00:00:10																																				

Construction Features					Miscellaneous Features				
Structural Defects					Service & Operational Observations				
STR No. Def	STR Peak	STR Mean	STR Total	STR Grade	SER No. Def	SER Peak	SER Mean	SER Total	SER Grade
0	0.0	0.0	0.0	1.0	0	0.0	0.0	0.0	1.0



### Section Inspection - 15/12/2022 - UPS3X

Item No. 7	Insp. No. 5	Date 15/12/22	Time 9:25	Client's Job Ref J-035641	Weather No Rain Or Snow	Pre Cleaned Yes	PLR UPS3X
Operator SEAN		Vehicle Not Specified		Camera Not Specified	Preset Length Not Specified	Legal Status Not Specified	Alternative ID 1

Town or Village:	Manorhamilton	Inspection Direction:	Downstream	Upstream Node:	UPS3
Road:	Sean Mcdermot St	Inspected Length:	0.95 m	Upstream Pipe Depth:	
Location:	Gardens (private)	Total Length:	0.95 m	Downstream Node:	MH2
Surface Type:		Joint Length:		Downstream Pipe Depth:	
Use:	Combined	Pipe Shape:	Circular		
Type of Pipe:	Gravity drain/sewer	Dia/Height:	100 mm		
Flow Control:	No flow control	Pipe Material:	Polyvinyl chloride		
Year Constructed:	Not Specified	Lining Type:	No Lining		
Inspection Purpose:	Routine inspection	Lining Material:	No Lining		

**Comments:**  
**Recommendations:**

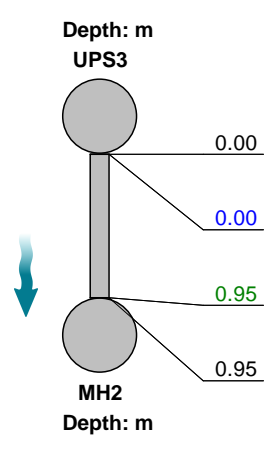
Scale:	1:50	Position [m]	Code	Observation	MPEG	Photo	Grade																												
<div style="display: flex; align-items: center;"> <div style="text-align: center; margin-right: 20px;"> <p>Depth: m</p> <p>UPS3</p>  <p>MH2</p> <p>Depth: m</p> </div> <table border="1" style="width: 100%; border-collapse: collapse;"> <tr> <td style="width: 15%;">0.00</td> <td style="width: 10%;">MH</td> <td style="width: 45%;">Start node, manhole, reference: UPS3</td> <td style="width: 10%;">00:00:00</td> <td></td> <td></td> <td></td> </tr> <tr> <td style="color: blue;">0.00</td> <td style="color: blue;">WL</td> <td style="color: blue;">Water level, 5% of the vertical dimension</td> <td style="color: blue;">00:00:01</td> <td></td> <td></td> <td></td> </tr> <tr> <td style="color: green;">0.95</td> <td style="color: green;">LU</td> <td style="color: green;">Line deviates up</td> <td style="color: green;">00:00:13</td> <td></td> <td></td> <td></td> </tr> <tr> <td style="width: 15%;">0.95</td> <td style="width: 10%;">MHF</td> <td style="width: 45%;">Finish node, manhole, reference: MH2</td> <td style="width: 10%;">00:00:14</td> <td></td> <td></td> <td></td> </tr> </table> </div>								0.00	MH	Start node, manhole, reference: UPS3	00:00:00				0.00	WL	Water level, 5% of the vertical dimension	00:00:01				0.95	LU	Line deviates up	00:00:13				0.95	MHF	Finish node, manhole, reference: MH2	00:00:14			
0.00	MH	Start node, manhole, reference: UPS3	00:00:00																																
0.00	WL	Water level, 5% of the vertical dimension	00:00:01																																
0.95	LU	Line deviates up	00:00:13																																
0.95	MHF	Finish node, manhole, reference: MH2	00:00:14																																
Construction Features				Miscellaneous Features																															
Structural Defects				Service & Operational Observations																															
STR No. Def	STR Peak	STR Mean	STR Total	STR Grade	SER No. Def	SER Peak	SER Mean	SER Total	SER Grade																										
0	0.0	0.0	0.0	1.0	0	0.0	0.0	0.0	1.0																										

Street

J-0356411

~~Manhattan~~  
Manhattan Leirium

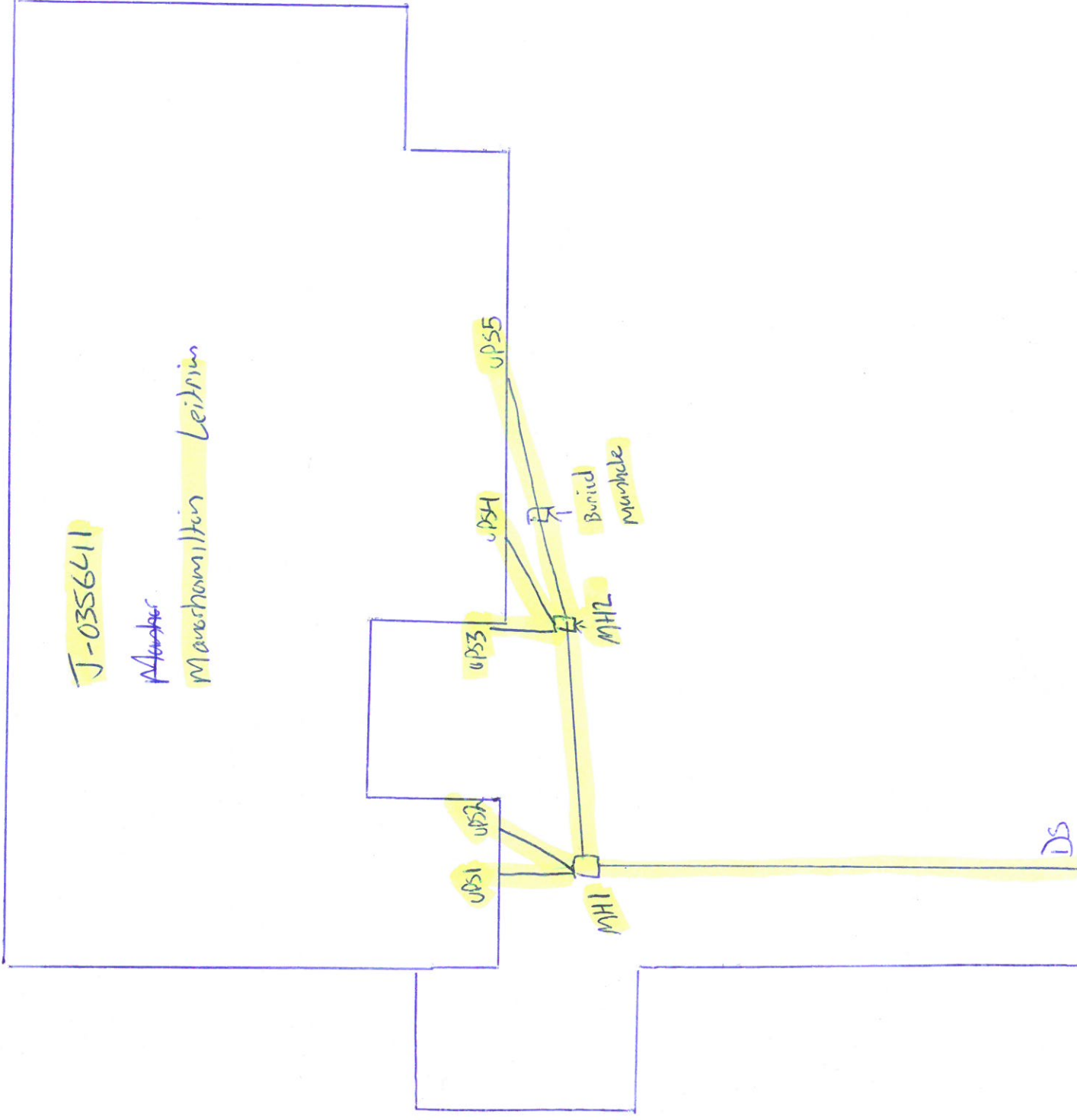

## Appendix B

### Uisce Eireann – Confirmation of Feasibility

## CONFIRMATION OF FEASIBILITY

Liam McElgunn

Unit 6  
Belturbet Business Park  
Creeny  
Belturbet  
Cavan  
H14AY93

Uisce Éireann  
Bosca OP 448  
Oifig Sheachadta na  
Cathrach Theas  
Cathair Chorcaí

Uisce Éireann  
PO Box 448  
South City  
Delivery Office  
Cork City

[www.water.ie](http://www.water.ie)

2 November 2023

**Our Ref: CDS23008010 Pre-Connection Enquiry  
Castle Street, Manorhamilton, Leitrim**

Dear Applicant/Agent,

### **We have completed the review of the Pre-Connection Enquiry.**

Uisce Éireann has reviewed the pre-connection enquiry in relation to a Water connection for a Multi/Mixed Use Development of 4 unit(s) at Castle Street, Manorhamilton, Leitrim, (the **Development**).

Based upon the details provided we can advise the following regarding connecting to the networks;

- **Water Connection** - Feasible without infrastructure upgrade by Irish Water

This letter does not constitute an offer, in whole or in part, to provide a connection to any Uisce Éireann infrastructure. Before the Development can be connected to our network(s) you must submit a connection application and be granted and sign a connection agreement with Uisce Éireann.

As the network capacity changes constantly, this review is only valid at the time of its completion. As soon as planning permission has been granted for the Development, a completed connection application should be submitted. The connection application is available at [www.water.ie/connections/get-connected/](http://www.water.ie/connections/get-connected/)

### **Where can you find more information?**

**Stiúthóirí / Directors:** Tony Keohane (Cathaoirleach / Chairman), Niall Gleeson (POF / CEO), Christopher Banks, Fred Barry, Gerard Britchfield, Liz Joyce, Patricia King, Eileen Maher, Cathy Mannion, Michael Walsh.

**Oifig Chláraithe / Registered Office:** Teach Colvill, 24-26 Sráid Thalbóid, Baile Átha Cliath 1, D01 NP86 / Colvill House, 24-26 Talbot Street, Dublin, Ireland D01NP86

Is cuideachta ghníomhaíochta ainmnithe atá faoi theorainn scaireanna é Uisce Éireann / Uisce Éireann is a design activity company, limited by shares. Cláraithe in Éirinn Uimh.: 530363 / Registered in Ireland No.: 530363.

- **Section A** - What is important to know?

**This letter is issued to provide information about the current feasibility of the proposed connection(s) to Uisce Éireann's network(s). This is not a connection offer and capacity in Uisce Éireann's network(s) may only be secured by entering into a connection agreement with Uisce Éireann.**

For any further information, visit [www.water.ie/connections](http://www.water.ie/connections), email [newconnections@water.ie](mailto:newconnections@water.ie) or contact 1800 278 278.

Yours sincerely,



---

**Dermot Phelan**  
**Connections Delivery Manager**

## Section A - What is important to know?

What is important to know?	Why is this important?
<b>Do you need a contract to connect?</b>	<ul style="list-style-type: none"> <li>• Yes, a contract is required to connect. This letter does not constitute a contract or an offer in whole or in part to provide a connection to Uisce Éireann's network(s).</li> <li>• Before the Development can connect to Uisce Éireann's network(s), you must submit a connection application <u>and be granted and sign</u> a connection agreement with Uisce Éireann.</li> </ul>
<b>When should I submit a Connection Application?</b>	<ul style="list-style-type: none"> <li>• A connection application should only be submitted after planning permission has been granted.</li> </ul>
<b>Where can I find information on connection charges?</b>	<ul style="list-style-type: none"> <li>• Uisce Éireann connection charges can be found at: <a href="https://www.water.ie/connections/information/charges/">https://www.water.ie/connections/information/charges/</a></li> </ul>
<b>Who will carry out the connection work?</b>	<ul style="list-style-type: none"> <li>• All works to Uisce Éireann's network(s), including works in the public space, must be carried out by Uisce Éireann*.</li> </ul> <p>*Where a Developer has been granted specific permission and has been issued a connection offer for Self-Lay in the Public Road/Area, they may complete the relevant connection works</p>
<b>Fire flow Requirements</b>	<ul style="list-style-type: none"> <li>• The Confirmation of Feasibility does not extend to fire flow requirements for the Development. Fire flow requirements are a matter for the Developer to determine.</li> <li>• <b>What to do?</b> - Contact the relevant Local Fire Authority</li> </ul>
<b>Plan for disposal of storm water</b>	<ul style="list-style-type: none"> <li>• The Confirmation of Feasibility does not extend to the management or disposal of storm water or ground waters.</li> <li>• <b>What to do?</b> - Contact the relevant Local Authority to discuss the management or disposal of proposed storm water or ground water discharges.</li> </ul>
<b>Where do I find details of Uisce Éireann's network(s)?</b>	<ul style="list-style-type: none"> <li>• Requests for maps showing Uisce Éireann's network(s) can be submitted to: <a href="mailto:datarequests@water.ie">datarequests@water.ie</a></li> </ul>

<p><b>What are the design requirements for the connection(s)?</b></p>	<ul style="list-style-type: none"> <li>• The design and construction of the Water pipes and related infrastructure to be installed in this Development shall comply with <i>the Uisce Éireann Connections and Developer Services Standard Details and Codes of Practice</i>, available at <a href="http://www.water.ie/connections">www.water.ie/connections</a></li> </ul>
<p><b>Trade Effluent Licensing</b></p>	<ul style="list-style-type: none"> <li>• Any person discharging trade effluent** to a sewer, must have a Trade Effluent Licence issued pursuant to section 16 of the Local Government (Water Pollution) Act, 1977 (as amended).</li> <li>• More information and an application form for a Trade Effluent License can be found at the following link: <a href="https://www.water.ie/business/trade-effluent/about/">https://www.water.ie/business/trade-effluent/about/</a></li> </ul> <p>**trade effluent is defined in the Local Government (Water Pollution) Act, 1977 (as amended)</p>