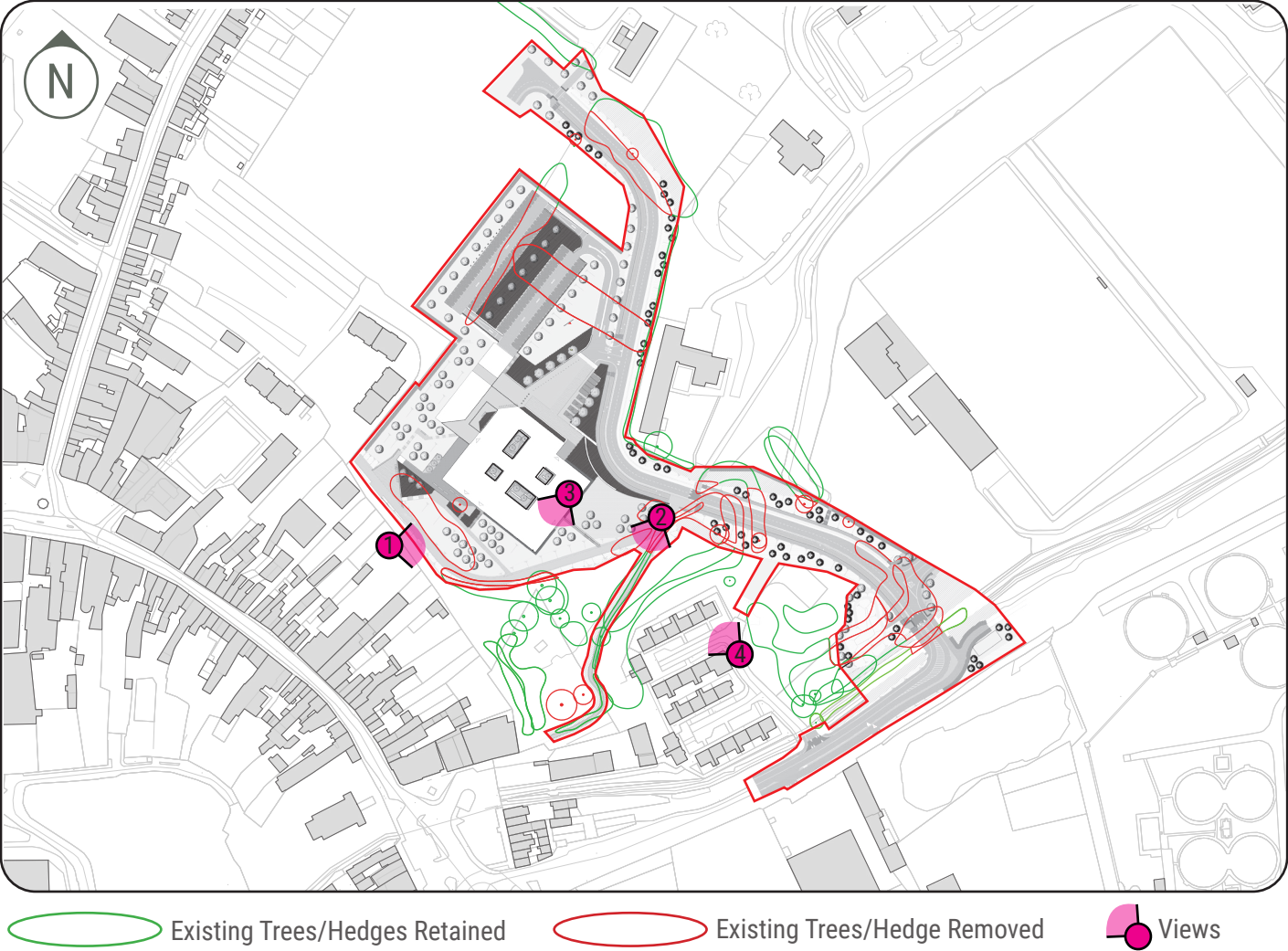



Fig11. Plan Showing Existing Vegetation to be Removed



View 01: Existing Vegetation at St Davnet's Row



View 02: Existing vegetation at Infirmary Hill and Davnet's Row

## 4.1 Existing Soft Landscape - Retained, Removed & Proposed

MCC instructed a qualified Arboriculturist to produce a Tree Survey for the Roosky Lands. The Survey identified individual trees, tree groups and hedgerows. These were then ranked in order of amenity value, identification of diseased, dead or dying specimens and recommendations for tree surgery or monitoring. It is noted in the tree survey report that the oldest trees are mature Ash and Beech growing on lands associated with the demolished infirmary. On inspection many of the Ash trees are suffering with Ash dieback (*Hymenoscyphus fraxineus*), some of which have been marked for felling within and outside the redline boundary. It is noted that most of the remaining younger Ash will succumb to this disease within the next 10 years or so. The commercial Sitka spruce plantation along the Ulster Canal Greenway are also showing signs of excessive deaths, with recommendations for felling due to their limited life expectancy. Refer to the Arboricultural Report for detailed information.

Trees that are proposed to be retained will be subject to protection in accordance with BS 5837, where root protection areas are applied by use of fixed protective fencing during construction. To facilitate the construction of footpaths, cycle routes, roads and infrastructure there will be some removal of existing Trees and hedgerows which has been kept to the minimum. In order to create accessible routes there will be ground modelling and engineered embankments to ensure that gradients are aligned with MCC Area Engineers requirements. Embankments will be planted with native species.

The landscape proposals provide for replacement planting to offset the removal of trees and hedgerows. The proposed Boundary Hedgerows are a native mix of four species planted in triple staggered rows with 5% planted as Standard Trees 8-10cm girth 2m height to create a variation of maturity to assist with accelerating replacement with the aim of knitting these into the existing wildlife corridors. There are an additional 176 mainly native individual Trees being proposed across the site the majority of which are Heavy Standards 12-14cm girth up to 3m height. Refer to Landscape Layout drawings 100, 101 and 102 for planting species and schedules.



View 03: Existing self seeded vegetation looking south



View 04: Existing screen planting to Roosky Vale