

1. Existing Ground Floor Plan  
1:200

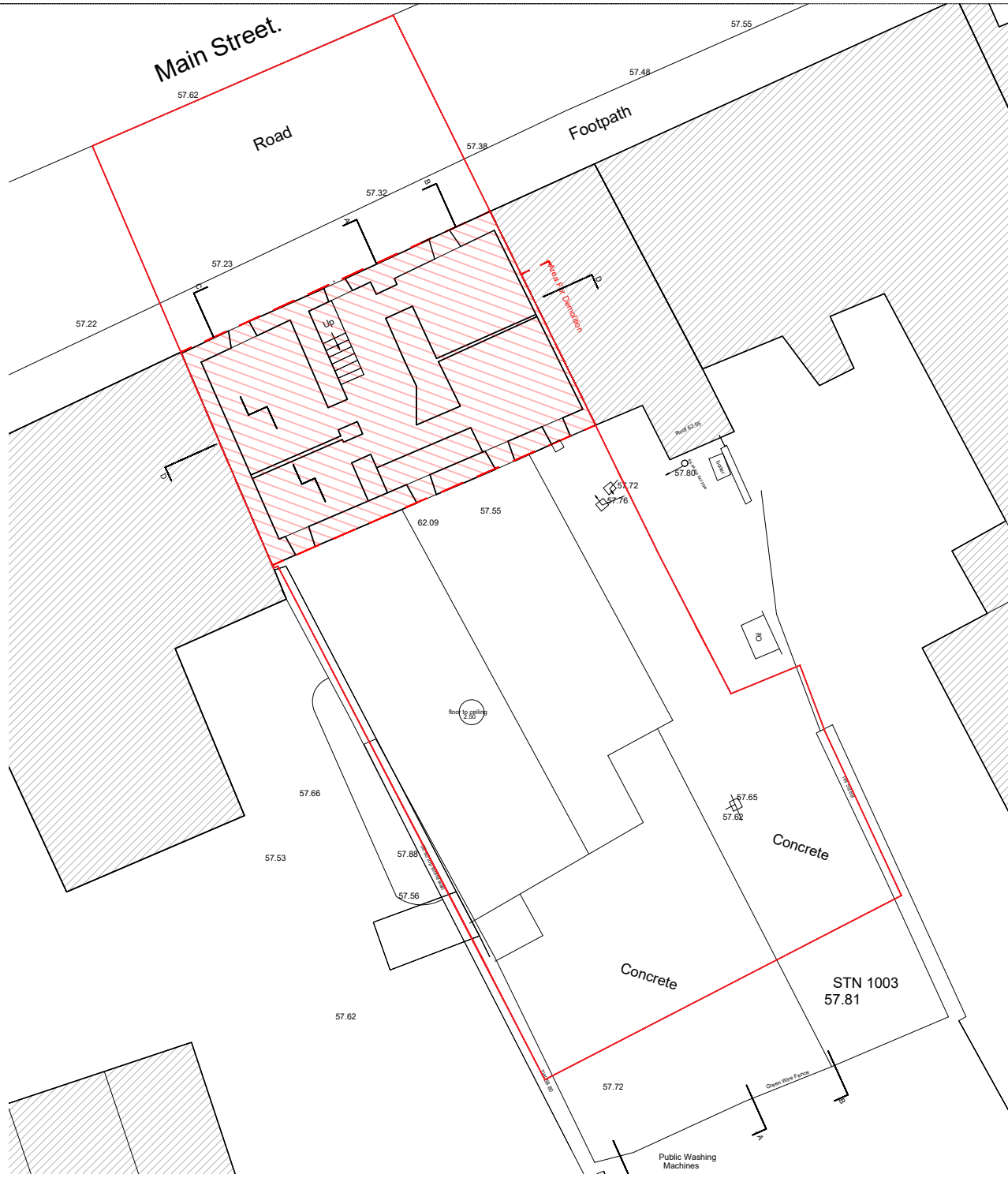

2. Existing First Floor Plan  
1:200

Legend:  
 Area of demolition

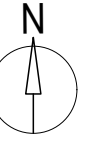

Scale 1:100 (m.)  
 0 1 2 5

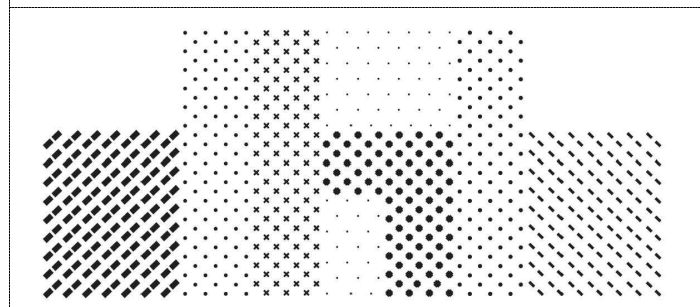

**dhbarchitects**

St. Catherines Hall  
 Catherine Street  
 Waterford City  
 X91 RX99, Ireland.

+353 (0)51 858121  
 info@dhbarchitects.ie  
 www.dhbarchitects.ie



Project:  
 Proposed Housing Development  
 Ballinamore Co. Leitrim

Client:  
 Leitrim County Council

Drawing Title:  
 Existing Ground and First Floor Plans

Scale:  
 1:200/A3

Drawn by:  
 CH

Approved by:  
 HB

Stage:  
 Part 8 Planning

Project No.:  
 22-04-LBK

Drawing No:

**PL-102**

Date:  
 19/04/2024

Revision:

**C**